

## Model: VBD-024-030VTD2JV2

<b>Input Voltage:</b>	100 – 277V AC
<b>Input Current at Max Load:</b>	0.5A
<b>Frequency:</b>	50/60 Hz
<b>Output Voltage:</b>	24V DC
<b>Output Current:</b>	1.25 A
<b>Max Power:</b>	30 W
<b>Dimensions L x W x H:</b>	332 x 78 x 38 mm
<b>Class Certification:</b>	Class 2/Class P/Type HL
<b>Weight:</b>	0.812 kg
<b>IP Rating:</b>	IP20 (Dry and Damp Locations)
<b>Dimmable:</b>	Triac/0/1-10V (5 in 1 Dimming)
<b>Wiring/Housing:</b>	Hardwire
<b>Operating Temperature:</b>	at least 90°C
<b>Standards:</b>	FC/UL/RoHS

## ORDER INFORMATION

Please fill out the below interactive form and press the **SUBMIT** button to send it electronically.

**Name:** \_\_\_\_\_

**Project Name:** \_\_\_\_\_

**Email:** \_\_\_\_\_

**Phone:** \_\_\_\_\_

**Quantity:** \_\_\_\_\_

**Notes:** \_\_\_\_\_

### Installation Diagram (with 0-10V Dimmers)

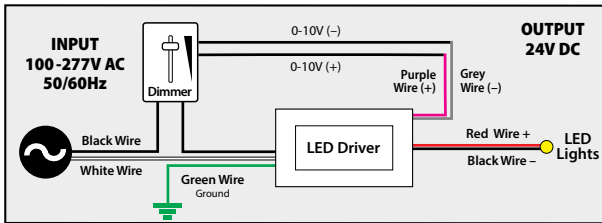

### (with Triac and Phase-cut Dimmers)

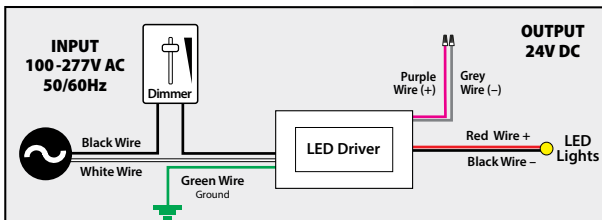

## Dimming

Veroboard 5 in 1 Dimming Constant Voltage LED drivers work with any standard Leading Edge, MLV, TRIAC or 0-10V dimmers. The dimmer switch must be installed on the 120V AC side of the driver.

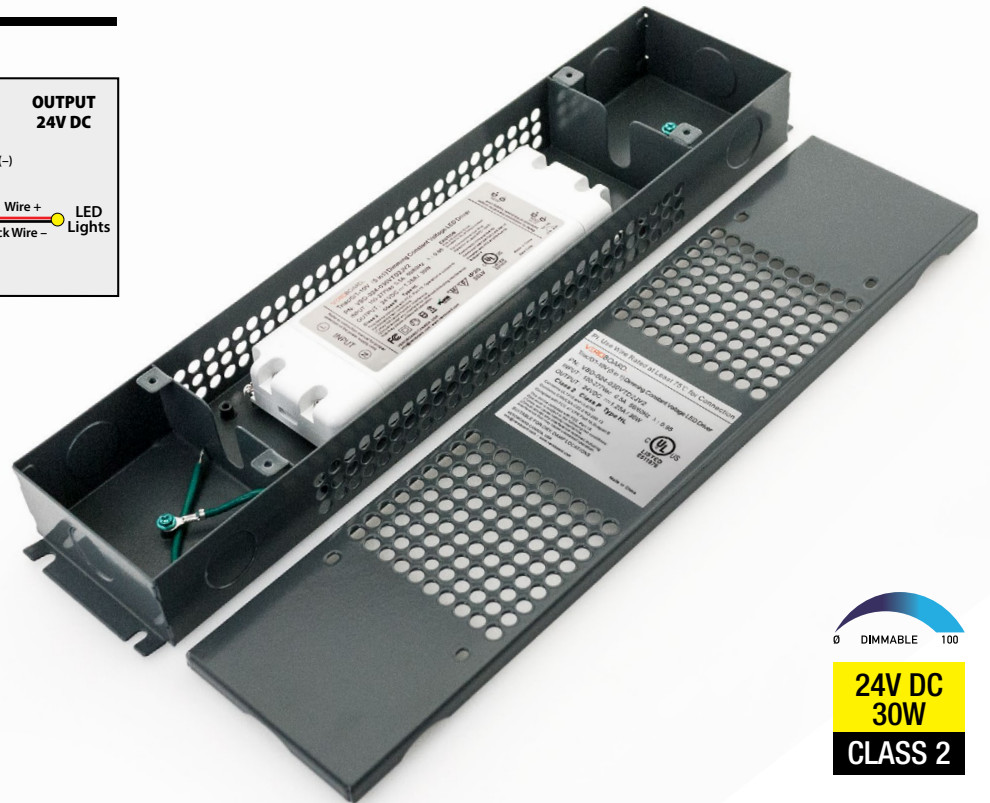
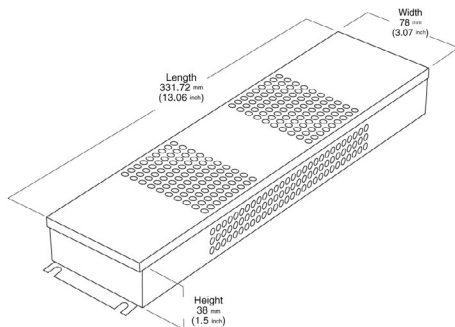

**24V DC**  
**30W**  
**CLASS 2**

**SKU: 666561419202**