

Model: VBD-012-030VTD2JV2

| | |
|-----------------------------------|--------------------------------|
| Input Voltage: | 100 – 277V AC |
| Input Current at Max Load: | 0.5 A |
| Frequency: | 50/60 Hz |
| Output Voltage: | 12V DC |
| Output Current: | 2.5 A |
| Max Power: | 30 W |
| Dimensions L x W x H: | 332 x 78 x 38 mm |
| Class Certification: | Class 2/Class P/Type HL |
| Weight: | 0.824 kg |
| IP Rating: | IP20 (Dry and Damp Locations) |
| Dimmable: | Triac/0/1-10V (5 in 1 Dimming) |
| Wiring/Housing: | Hardwire |
| Operating Temperature: | at least 90°C |
| Standards: | FC/UL/RoHS |

ORDER INFORMATION

Please fill out the below interactive form and press the **SUBMIT** button to send it electronically.

Name: _____

Project Name: _____

Email: _____

Phone: _____

Quantity: _____

Notes: _____

Installation Diagram (with 0-10V Dimmers)

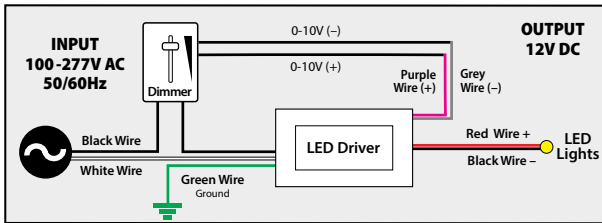

(with Triac and Phase-cut Dimmers)

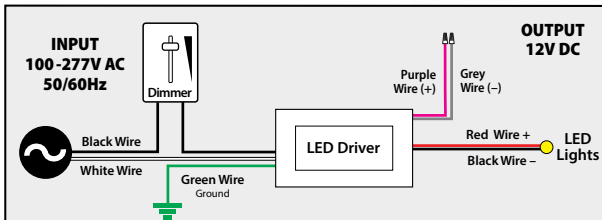

Dimming

Veroboard 5 in 1 Dimming Constant Voltage LED drivers work with any standard Leading Edge, MLV, TRIAC or 0-10V dimmers. The dimmer switch must be installed on the 120V AC side of the driver.

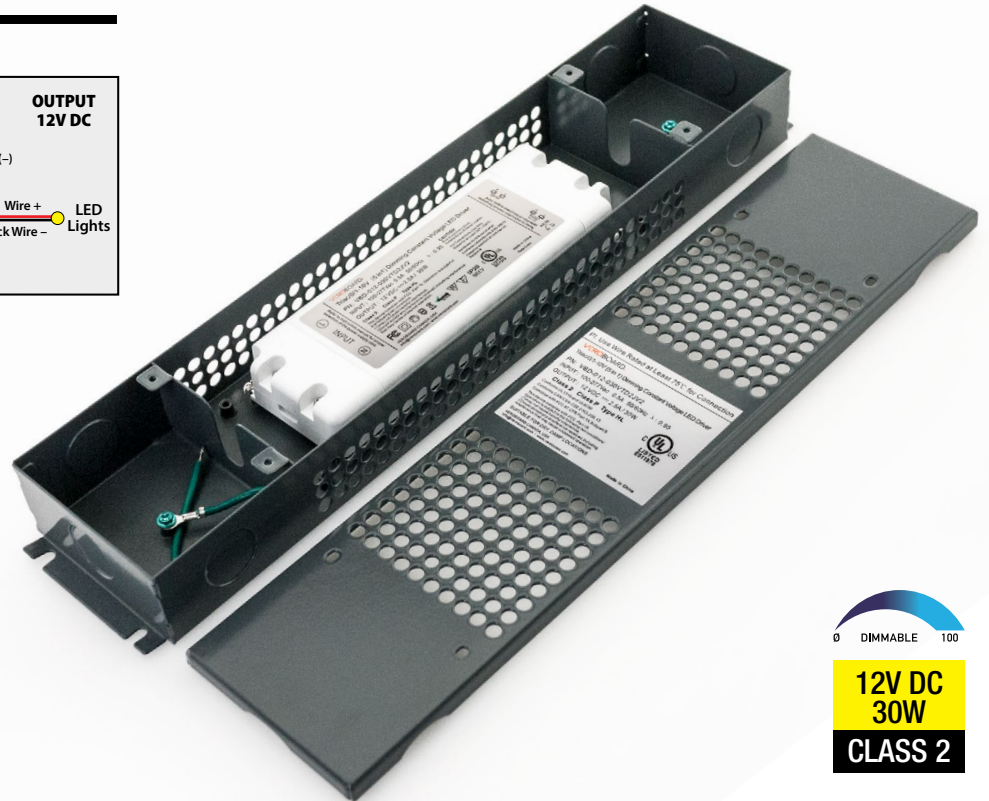
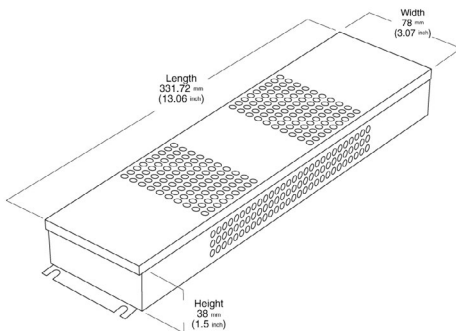

12V DC
30W
CLASS 2

SKU: 666561419196